

quick guide

vigilec zero press doble sensor - V2ZPS

internal configuration

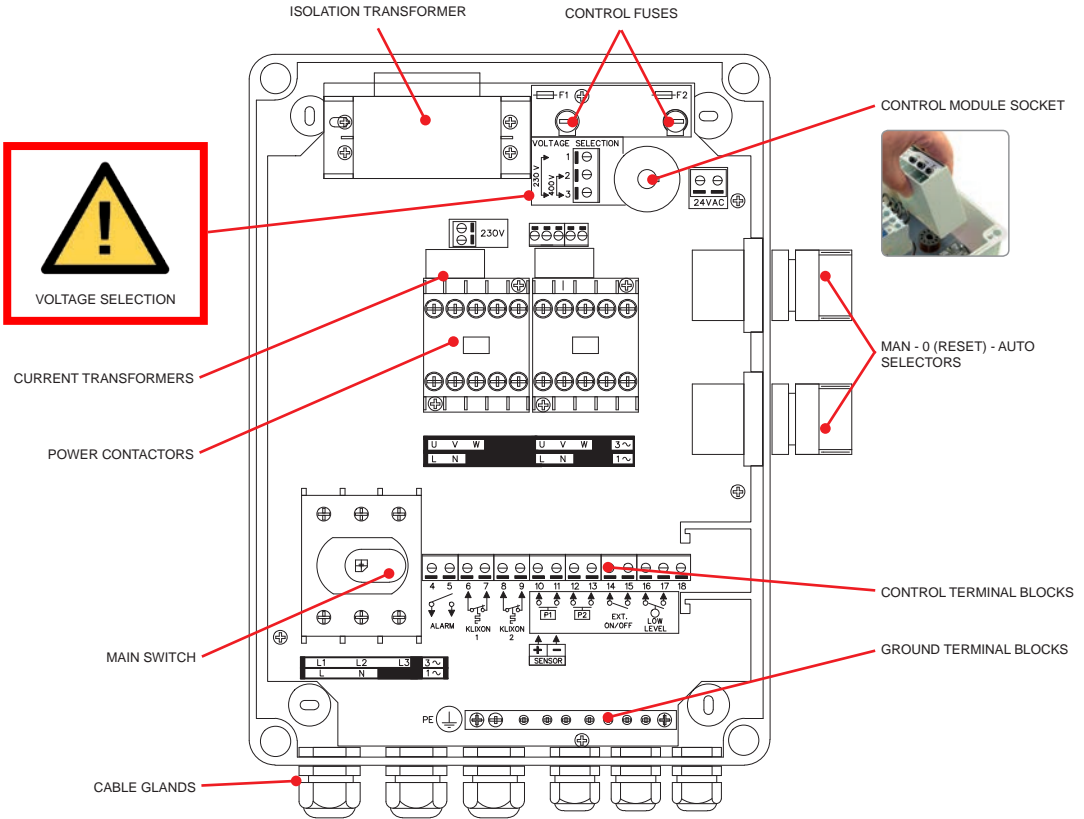

control module

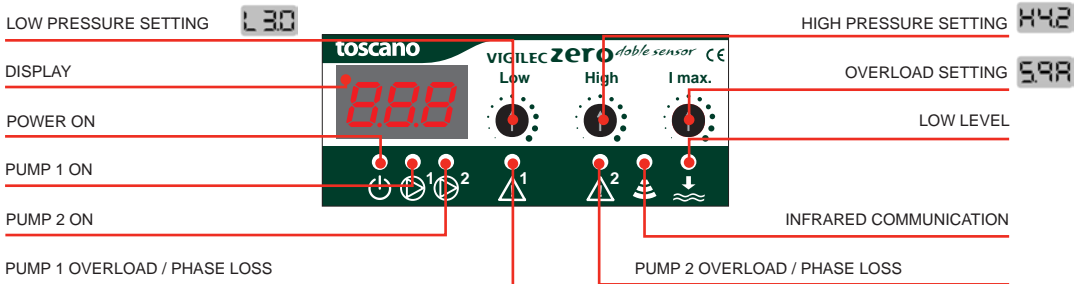

installation

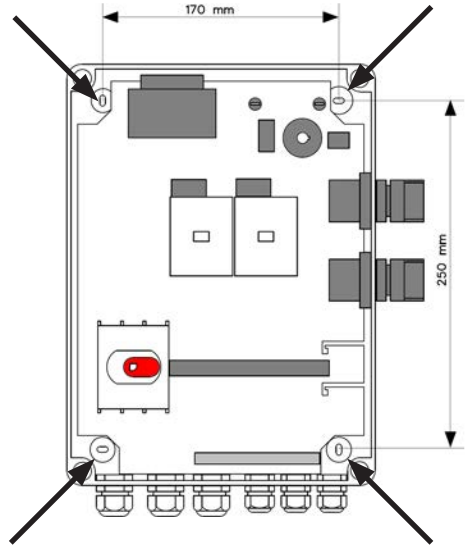
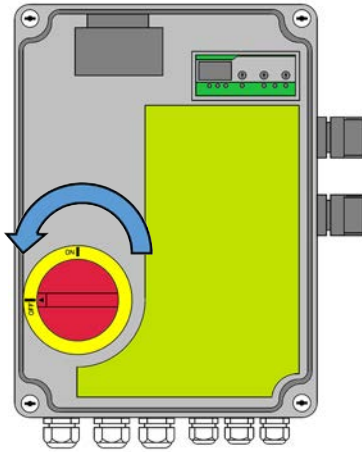

voltage selection

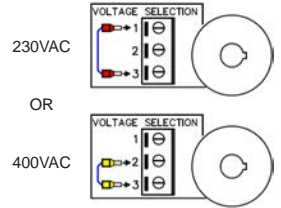
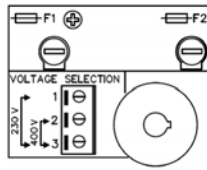

power connections

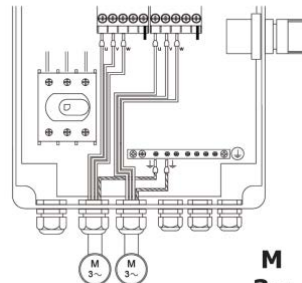
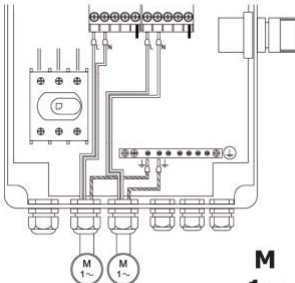
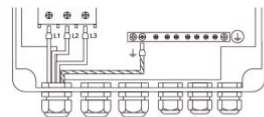
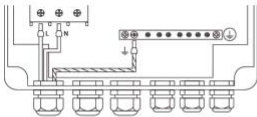

control connections

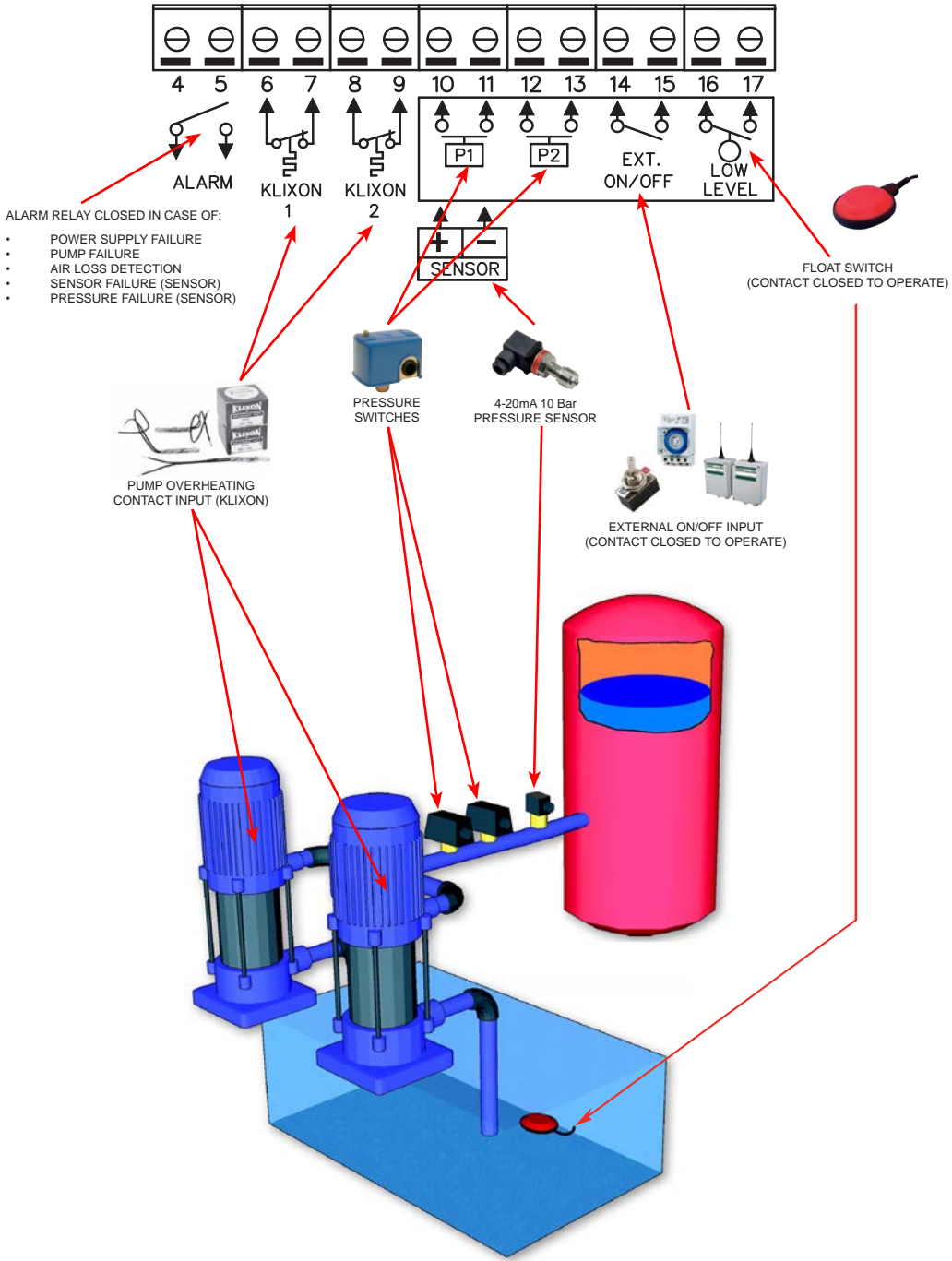

selectors

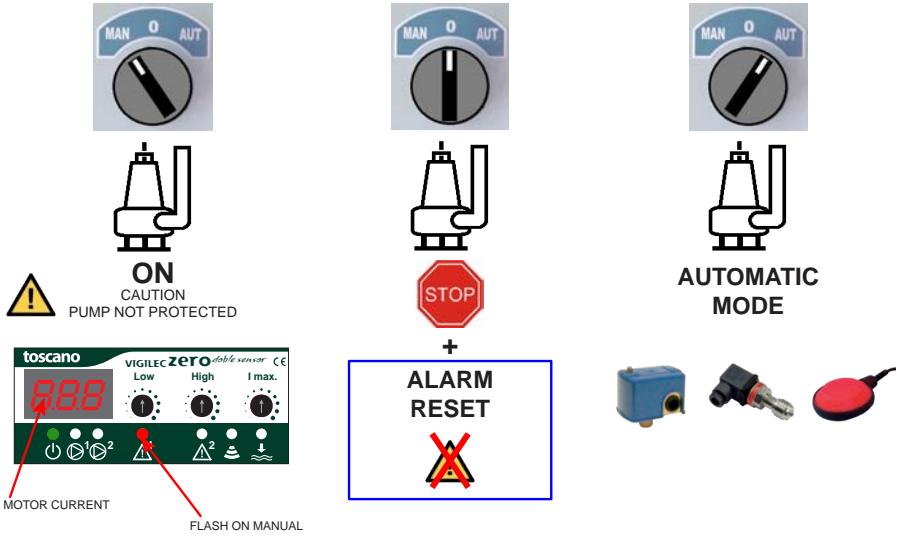

set-up

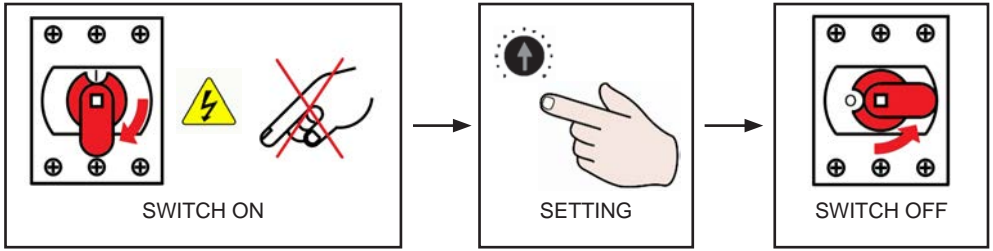

control mode selection

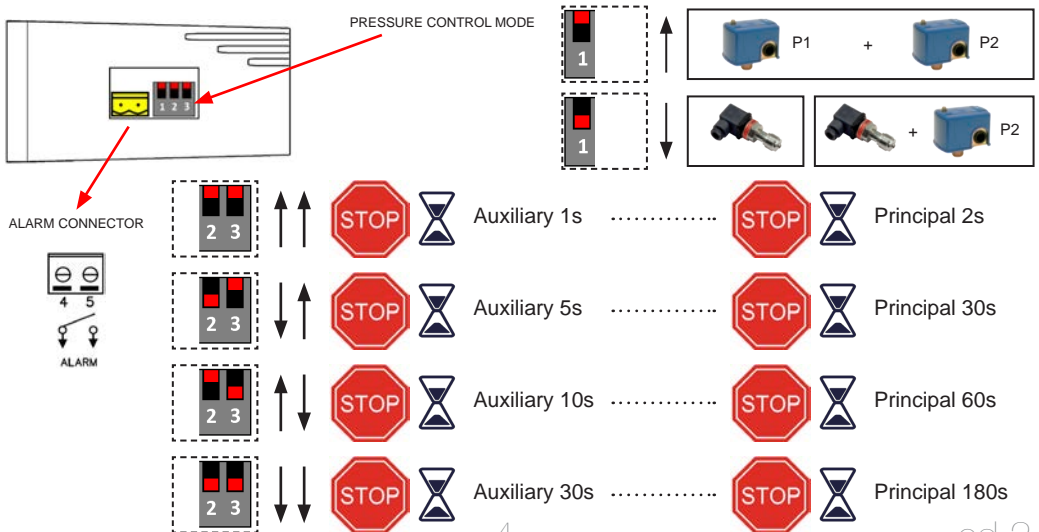

pressure switch operation mode

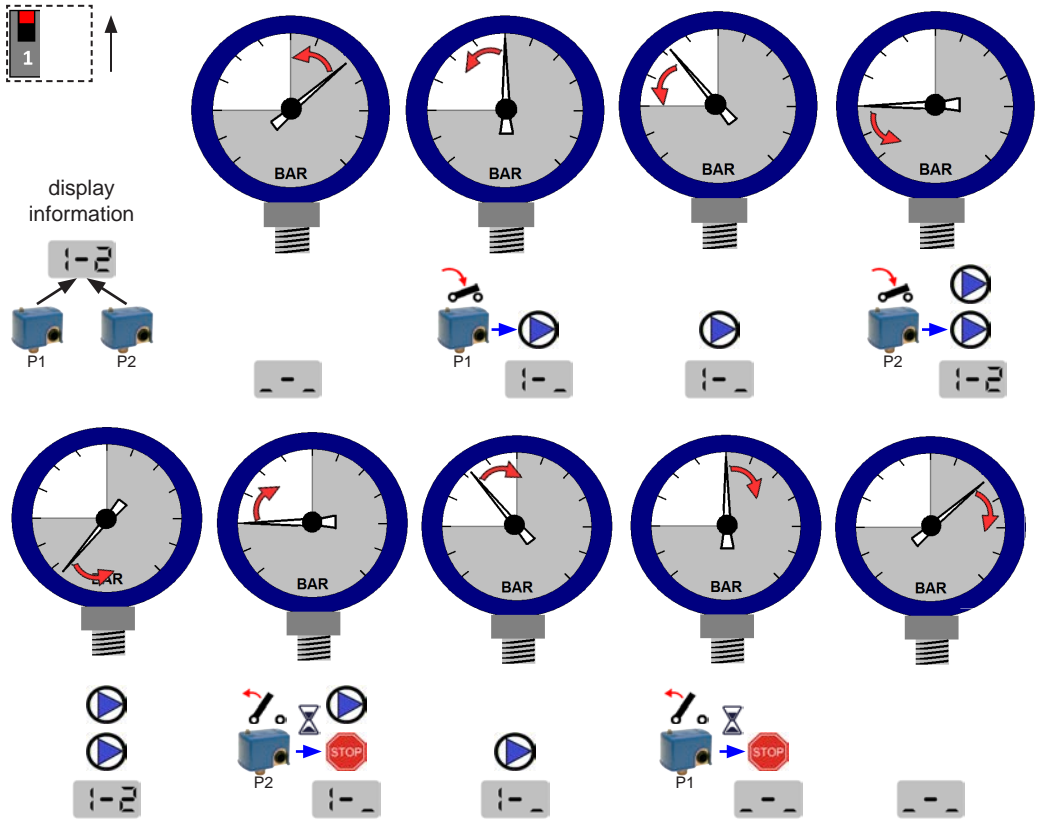

4-20mA pressure sensor operation mode

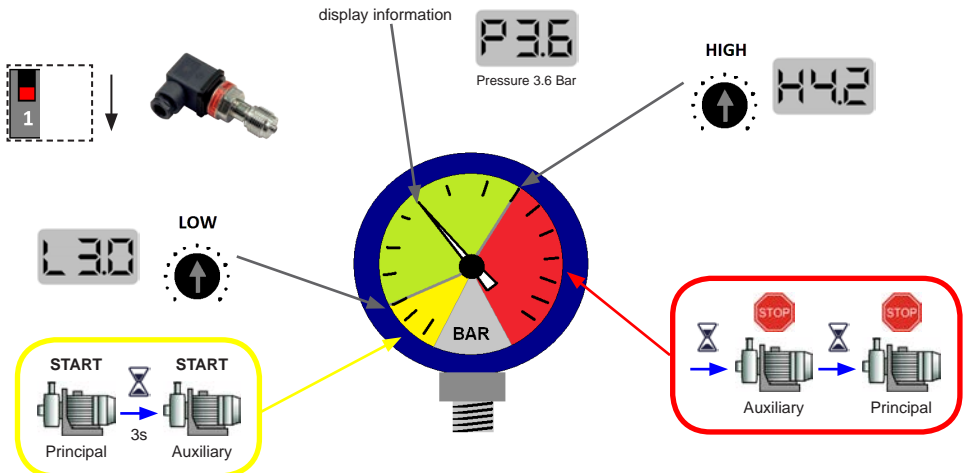

problem detection
supply failure

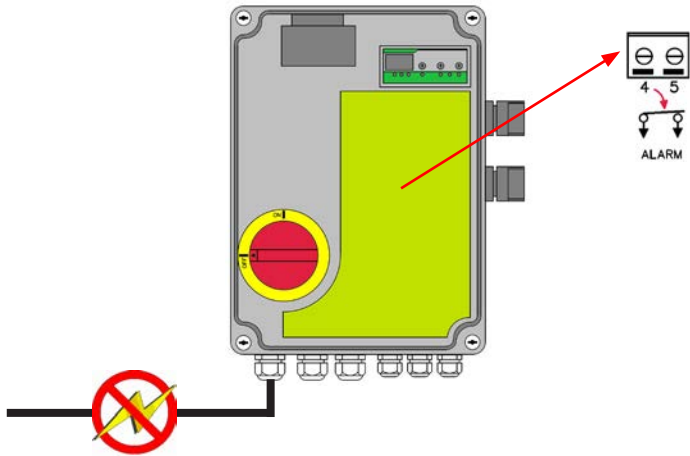

pump failure

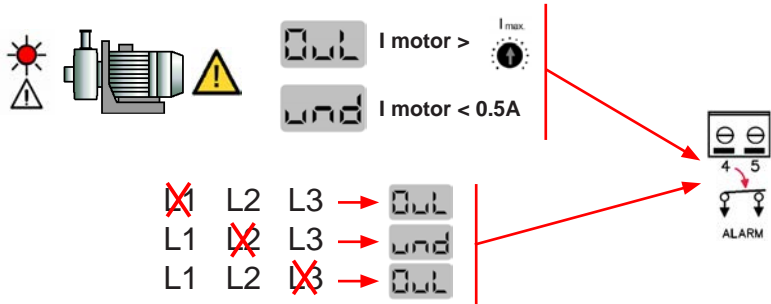

air error detection

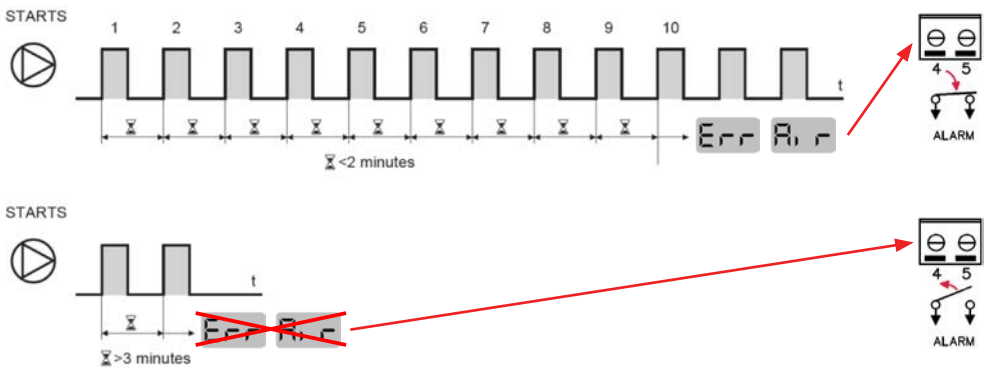

sensor failure (4-20mA sensor control)



pressure error (4-20mA sensor control)

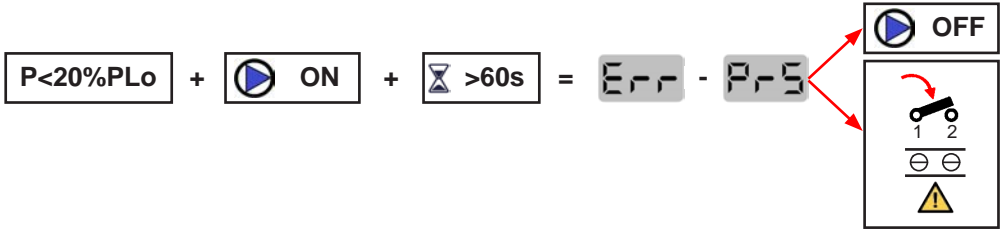

Pump-Check

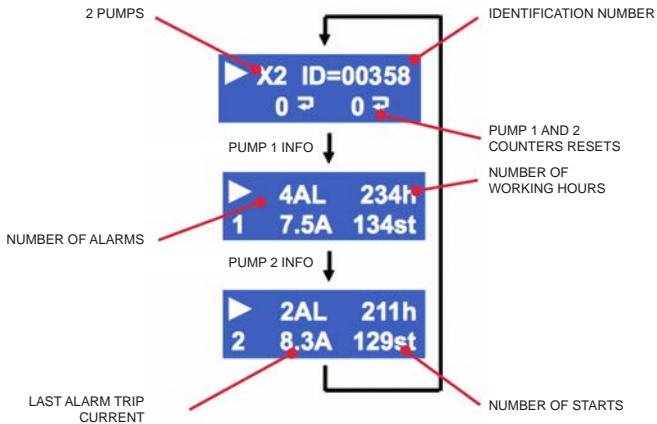

other functions / additional options

- Pump alternation with delayed start and stop for pumps.
- Automatic pump commutation in case of failure or deactivation of one of them.
- Additional options: main circuit breaker, bimetallic overload relay or phase sequence relay.

optional modules (direct installation on control terminal blocks)

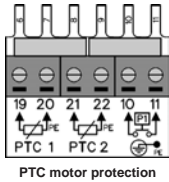

~~Klixon~~

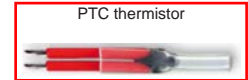

technical specifications

Supply voltage	230Vac I/III or 400Vac III (selectable) -20%...+30% - 50/60Hz
Control transformer	230-400Vac / 24Vac, primary fuse: 0.2A (F1), secondary fuse: 0.8A (F2)
Pump current range	1...12A (V2ZPS) / 5...16A (V2ZPS-E) / 5...22A (V2ZPS-F) - AC3
Overload setting (Imax)	1.1...1.3A (V2ZPS) / 5.1...30A (V2ZPS-E/F) / alarm trip in 7 seconds
Control mode	Pressure switches or 4-20mA pressure sensor
Control input voltage	24Vdc (pressure switches, low level float switch and external ON/OFF control)
4-20mA sensor supply voltage	24Vdc
Sensor range	10 Bar
Sensor failure detection	Open circuit and short circuit
Low pressure setting	0.1...9.8 Bar
High pressure setting	0.3...10 Bar
Minimum distance between PHi and PLo	0.2 Bar
Terminal blocks wiring size	10mm ² (power supply) 4mm ² (control)
Protections	Overload, phase failure and pump overheating (Klixon contacts)
Alarm contact	5A 250Vac
Alarm contact activation	Overload, phase failure, sensor failure, power supply failure, air error and pressure error.
Recorded information (PUMPCHECK)	Module identification number, counters resets, pump operation hours, pumps starts, pumps alarms and last alarm tripping current.
Size/Weight/IP/Temperature	300 (h) x 220 (w) x 120 (d) mm / 3550g / IP65 / -10°...+55° C
Cable gland configuration	1xM25 (main supply) / 2xM20 (motors) / 6xM16 (controls)